

## 26" Former

### THE MP 26" STAINLESS STEEL FORMER FEATURES THE OPTIONAL PATENTED MULTI-FLOW® SYSTEM FOR THE HIGHEST PRODUCTION REQUIREMENTS

- Patented Multi-Flow®
- Capabilities
  - Up to 110 SPM
  - Production rates of up to 9000#/hr.
  - 9", 10" & 13" stroke lengths offered
- Heavy-duty parts include
  - Winsmith
  - Connecting rod
  - KO drive
  - Feed screw system
- Stainless steel package standard
- NEMA 4X style door package
- Stainless steel hydraulic reservoir standard
- Touchscreen with PLC controls and options
  - left hand controls
  - wireless communication system for remote monitoring, trending, reporting, etc.
  - customized to operator's specifications
- Control packages available
  - OPTO 22
  - Allen Bradley
- Tomahawk/Certified MP Former parts for sales and rebuilds
- Rebuild/Loaner programs

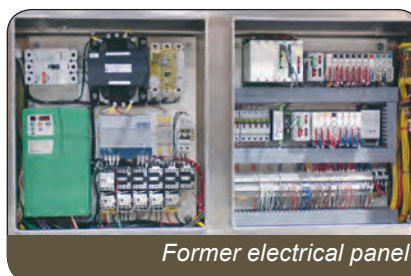

# 26" Former

## Technical Information

### MACHINE SPECIFICATIONS

Machine	A	B	C
26" Former	81.5"	115"	55.5"

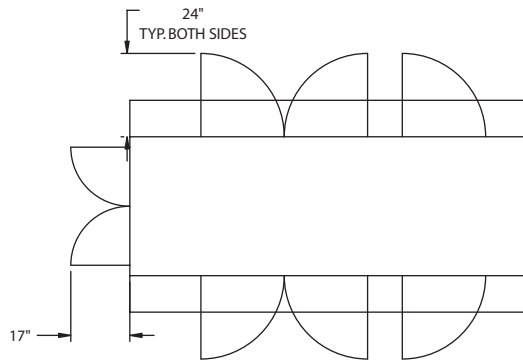
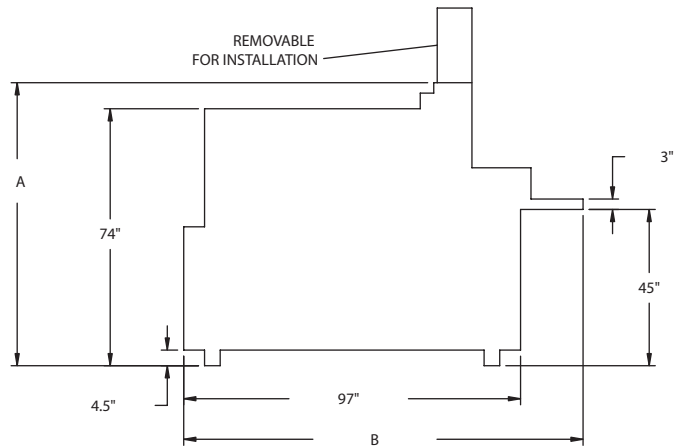
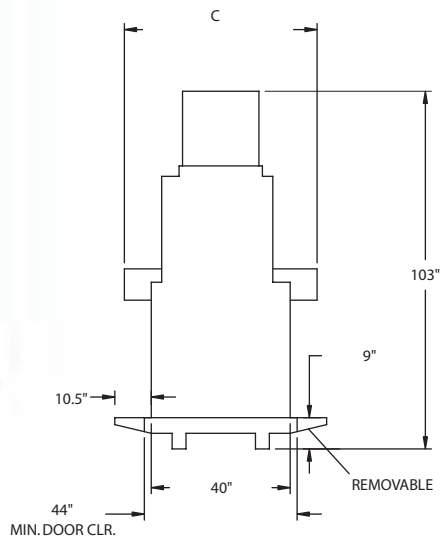

### UTILITIES (26" FORMER)

<b>Power/Voltage</b>	50 Hz/380, 420 or 575, 3 Phase/32 kVA Service 60 Hz/200, 230 or 460, 3 Phase/30 kVA Service NEMA 4X Circuit Breaker		
<b>Stroke Length</b>	9", 10" or 13"		
<b>Water</b>	1 GPM/4.5 Liters/minute	Jacketed Oil Cooler	
<b>Heavy Duty</b>	Feed Screw Housing	Feed Screws	Over Arm
<b>Improved Sanitation Features</b>	Upper Right Angle Drive Stainless Steel Stainless Steel Hydraulic Reservoir		
<b>Comments</b>	9000 Pounds Per Hour Touch Screen Interface Adjustable Speed 15-110 Strokes Per Minute Single Piece Aluminum Billet Feed Screw Housing Gross Weight: 7600 lbs/3447 kgs W/O Paper Feed 8100 lbs/3674 kgs		

Specifications subject to change

### - SERVICES OFFERED -

- 24/7 Service
- Spare Parts Department
- Application Support
- Technical Support
- Line Audits

### - MP WARRANTY POLICY -

*MP Equipment will repair or replace any MP manufactured component that fails due to defect in material or workmanship within 24 months from shipment.*

*All OEM parts covered by individual warranties.*

**MP** EQUIPMENT COMPANY

Your Best Value for Processing Solutions

