

RapidPak RP-25



Most Advanced Sanitary Design in the Packaging Industry

- Enhances access and cleanability; reduces food safety concerns
- Dairy 3A sanitation standard compliance
- Potential for lower swab counts and longer shelf life



Exceptionally High Cycle Rates Through the Use of Servo Motor Technology

- Replaces two competitive machines with one RapidPak

Mechanical Simplicity; Fewer Moving Parts

- Reduces downtime, maintenance costs, and part costs
- Reduces the need for trained expert personnel



Readily Available Parts and Components

- Fewer consumables; lower usage cost improves purchase justification
- Industry standard, off-the-shelf components

Allen Bradley CompactLogix System and Modem

- Faster, easier maintenance
- 24/7 modem service

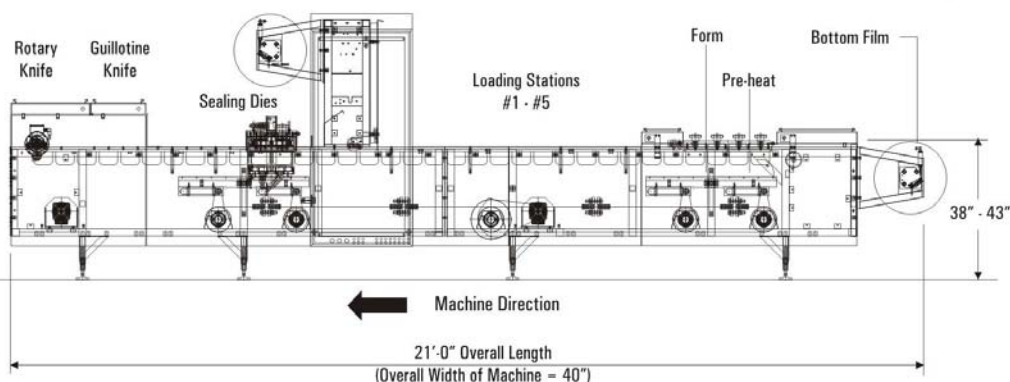
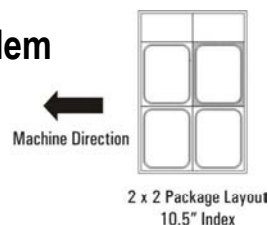

RapidPak RP-25



Sanitary Tubular Frame

SPECIFICATIONS:

- Up to 5.5" (140 mm) depth of draw.
- Up to 14" (355 mm) index.
- Flexible or rigid film.
- Custom frame welded and machined to ± 0.001 " tolerance ensures consistent, long-term performance and reduces parts wear.

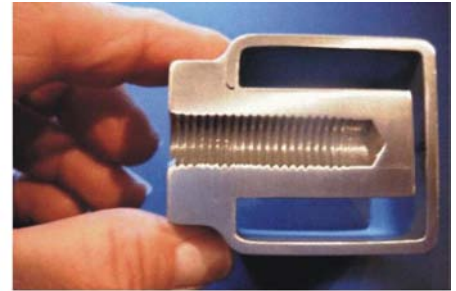

Hermetically Sealed Weldments

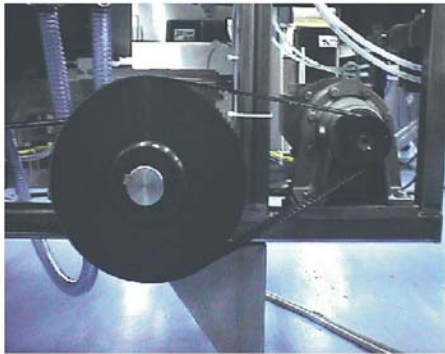

Servo Motor Precision

- Guards remain on machine:
 - Eliminates handling
 - Easy-open access
- Servo motors on all major machine functions. Continual feedback allows Servos to move faster, smoother, and more accurate in pneumatic systems.



Sanitary Tilt-Away Guards

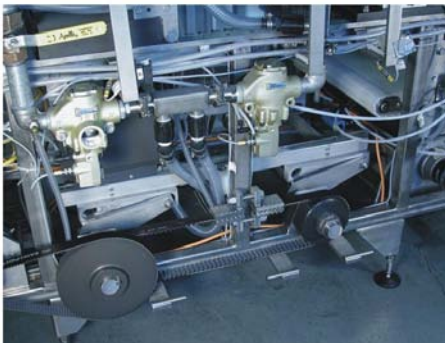

Servo-Driven Die Closing Lift System

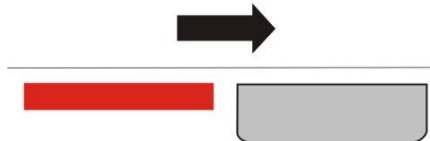

- Separate pre-heat is more hygienic, maximizes heating and forming times, and allows faster cycle rates.

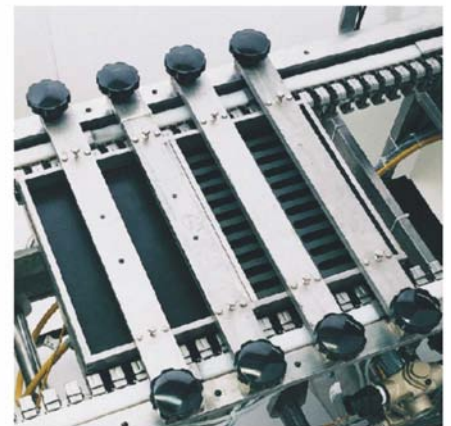

Pre-Heat Forming System

- NEMA 4 watertight components ensure reliable start-up after aggressive cleaning.

- Easily sourced parts; lower annual cost.



Allen Bradley
PanelView Plus Touchscreen

UTILITIES

- Electrical: 230/3/60. Amperage to be determined once machine is configured.
- Compressed Air: Typically 2-3 cfm, 80-90 psi
- Water: 30-50 gallons per hour at 10-50 psi



Convenient Parts Sourcing